

The current process of checking capability

NW1001 ARMITAGE JN TO PRESTON FYLDE JN

SECTION		Periods A and B 15.12.2019 to 16.02.2020		Period C 17.02.2020 to 29.03.2020		Period D 30.03.2020 to 16.05.2020		Periods E to G 17.05.2020 to 13.09.2020		Periods H and J 14.09.2020 to 12.12.2020	
Lichtfield North Jn and Basford Hall Jn 1001.1 to 1001.7	WEEK END SUN/ MON										
Basford Hall Jn and Crewe South Jn 1001.8	MID WEEK WEEK END										

PLEASE SEE LONDON NORTH WESTERN (SOUTH SECTION 4)

RT3973/CON

SECTION 4

Route / Sector		Gauge											Notes	
		W6	W7	W8	W9	W9Plus	W10	W10A	W12					
Hagen Jn		Y	N	N	N	N	N	N	N	N	N	R1	R1	PROHIBITED on the Fast Lines PROHIBITED on the Up Fast between Holloway South Jn and Wood Green PROHIBITED on the Down Fast between Holloway South Jn and Wood Green PROHIBITED across Ferme Park Flyover PROHIBITED from Ferme Park sidings PROHIBITED from Horsey Depot and sidings PROHIBITED from Bounds Green Depot PROHIBITED from the Down Washer Carriage between Ferme Park and Wood Green South Jn PROHIBITED between Holloway Jn North and Finsbury Park (North) Jn on the Down Slow PROHIBITED between Holloway Jn South and Wood Green South Jn on the Up Fast PROHIBITED between Holloway Jn South and Wood Green South Jn on the Down Fast PROHIBITED between Harringay station and Wood Green South Jn on the Down Slow No 1 PROHIBITED from Huntingdon Up bay
alloway		Y*	R1	R1	R1	R1	R1	R1	R1	R1	R1	R1	R1	
th Jns - Wood		Y*	Y	Y	Y	Y	R1	R1	R1	R1	R1	R1	R1	
							R2	R2	R2	R2	R2	R2	R2	
							R3	R3	R3	R3	R3	R3	R3	
							R4	R4	R4	R4	R4	R4	R4	
							R5	R5	R5	R5	R5	R5	R5	
							R6	R6	R6	R6	R6	R6	R6	
							R7	R7	R7	R7	R7	R7	R7	
							R8	R8	R8	R8	R8	R8	R8	
							R9	R9	R9	R9	R9	R9	R9	
							R10	R10	R10	R10	R10	R10	R10	
							R11	R11	R11	R11	R11	R11	R11	

ADVICE TO TRAIN CREWS CONVEYANCE OF CONTAINERS

(To be handed to the TRAIN CREW at the starting point of the train, where load is attached or when signing on for duty)

Special Notes

(a) If you are relieved en route, this advice must be handed to the staff relieving you.

(b) If the load is staged without immediate relief of the yard staff who will be responsible for giving it to the train forward.

(c) At the termination of the journey this advice must be handed to the local train forward.

Date: _____

Train Identity: _____

From: **PORTBURY ALEXANDRA JUNCTION**

NATURE OF EXCEPTIONAL LOAD - W8 GAUGE

(1) CONTAINERS up to 8ft 2 1/2 in (2500mm)

INDEX Ref	ROUTE : Leeds -Selby - Hull Area		AEA	RA	Length LIMIT	LOCOMOTIVE TYPE																	
	From	To				MAXIMUM LOAD excluding locomotive weight																	
	Continued from previous page					20	31/1	33	37/0	37/4	37/7	47/0	56	57	58	59	60	66	66/6	67	FL PH	73/1	66H
LN/161	Micklefield Jn	Neville Hill Jn	6519	8	78	1245	820	1250	1590	2030	2035	1365	2225	1425	2120	3065	3565	2675	3410	810	645	3310	
	To Neville Hill Jn- Hunslet East Jn Ref LN/170 Page 31																						
LN/162	Neville Hill Jn	Leeds North Jn	6520	8	93	1715	1530	1815	2345	2490	2750	2545	2730	2875	2600	5405	5400	5270	5550	1775	1580	5270	
	To Leeds North Jn- Engine Shed Jn Ref LN/588 Page 61																						
	To Leeds North Jn- Whitehall Jn Ref LN/417 Page 49																						
	Hambleton East Jn Hambleton North Jn																						
LN/163	Hambleton East Jn	Hambleton North Jn	6560	10	121	1195	785	1200	1530	1965	1965	1310	2160	1370	2055	2955	3435	2575	3285	780	615	3185	
	To Hambleton North Jn-Colton Jn Ref LN/260 Page 37																						
LN/164	Hambleton North Jn	Hambleton East Jn	6561	10	78	1485	975	1480	1890	2300	2410	1605	2525	1680	2400	3590	4170	3135	3985	945	775	3875	
	To Hambleton East Jn-Selby West Jn Ref LN/142 Page 30																						

NESA (Sectional Appendices)

Consulted for route clearance information, such as gauge and route availability

- Web-based portal
- Users must search by LOR and again, piece information together

Line of Route	Line of Route / Sector Description	Gauge									Notes
		GB1/2	W6A	W7	W8	W9	W9Plus	W10	W10A	W12	
EA1010	Liverpool Street – Mile End	N	Y*	N	N	N	N	N	N	N	
EA1010	Mile End – Stratford Central Jn East	N	Y*	Y	Y	R1	N	N	N	N	R1 W9 between Bow Depot Jn and Carpenters Road South Jn only
EA1010	Stratford Central Jn East – Forest Gate Jn	N	Y*	Y	Y	Y	N	R1	N	N	R1 W10 Prohibited on Up and Down Electric between Maryland East Crossovers and Stratford Central Jn West.
EA1010	Forest Gate Jn – Seven Kings	N	Y*	Y	Y	Y	N	Y	N	N	
EA1011	Seven Kings – Ipswich	N	Y*	Y	Y	Y	N	Y	N	N	

RT3973 Forms

Provide dispensation for services to exceed published capability

- Over 500 PDF documents
- The correct form is bid for by FOCs
- All restrictions need to be pinpointed and complied with

ADVICE TO TRAIN CREWS
CONVEYANCE OF HEAVY AXLE WEIGHT WAGONS

(To be handed to the TRAIN CREW at the starting point of the train, where load is attached or when signing on for duty)

Special Notes

(a) If you are relieved en route, this advice must be handed to the staff relieving you.

(b) If the load is staged without immediate relief of the train crew, this advice must be handed to the local yard staff who will be responsible for giving it to the train crew working the train forward.

(c) At the termination of the journey this advice must be handed to the staff at the destination.

PARTICULARS OF SERVICES USED

Date:	Train Identity:	From: TUNSTEAD/ PEAK FOREST/ MOUNTSORREL/ EARLES SIDINGS/ LAFARGE DOWLOW/ WEST RUISLIP UP SIDINGS NORTH SIDE/ CREWE BASFORD HALL/ HINKSEY SIDINGS/ COCKSHUTE SIDINGS	To: DALLAM FREIGHT DEPOT/ ARPLEY YARD/ NORTHWICH TC/ OAKLEIGH SIDINGS/ HAMS HALL/ TELFORD FREIGHT TERMINAL/ WASHWOOD HEATH RMC/ WASHWOOD HEATH UP SIDINGS/ SMALL HEATH AGGREGATES/ WALSALL MIDLAND YARD/ CROFT QUARRY/ NORTHAMPTON FD/ BLETCHLEY RMC/ PARK ROYAL/ WILLESDEN F SIDINGS/ WILLESDEN EUROTERRMINAL/ ACTON YARD/ BRENTFORD/ HAYES AND HARLINGTON/ LANGLEY/ WEST DRAYTON/ WEST THURROCK/ BOW DEPOT/ BOW EAST/ DIDCOT TC/ BANBURY RESERVOIR SDGS/ PRINCES RISBOROUGH/ THEALE FY/ STOKE GIFFORD
-------	-----------------	--	---

RA OF VEHICLES: GENERATING UP TO RA10 ON TOPS

THE FOLLOWING ROUTES MUST BE OBSERVED:

Note: Unless shown otherwise, these routes apply in both directions

(A) Tunstead, Great Rocks Jn, Peak Forest, Chinley South Jn, Chinley East Jn, Earles Sidings (if required), Totley Tunnel East, Dore West Jn, Dore South Jn, Tapton Jn, Chesterfield, Clay Cross North Jn, Ambergate South Jn, Derby, London Road Jn, Stenson Jn, North Stafford Jn, Leicester Jn, Branston Jn, Wichnor Jn, Kingsbury Jn, Water Orton East Jn (via Fast Lines or Slow Lines and Whitacre Jn), **Hams Hall**, Water Orton West Jn, Castle Bromwich Jn, Washwood Heath East Jn, **Washwood Heath RMC** or Duddleston Jn (if required - including reversal),

Other Checks...



Section 4 possessions

LN101 KING'S CROSS TO SHAFTHOLME JN

London King's Cross to Hitchin North Jn Timetable Construction Notes	
Sat/Sun	All trains to be timed over the Slow lines between 2350 Sat and 0750 Sun with an additional [3] approaching Holloway in the Up and Hitchin in the Down.
Sun/Mon and Midweek	All trains to be timed over the Slow lines between 0001 MTWThF and 0545 MTWThF with an additional [3] approaching Holloway in the Up and Hitchin in the Down.
Hitchin North Jn to Huntingdon (Up) / Holme (Down) Timetable Construction Notes	
Sat/Sun	All trains to be timed over the Slow lines between 2350 Sat and 0750 Sun with an additional [3] approaching Hitchin Cambridge Jn in the Up and Fletton Jn in the Down.
Sun/Mon	All trains over the fasts to be timed with an additional [10] between 2300 SuMTWTh and 0600 MTWThF approaching Hitchin Cambridge Jn in the Up and Fletton Jn in the Down.
Midweek	All trains over the slows to be timed with an additional [3] between 2300 SuMTWTh and 0600 MTWThF approaching Hitchin Cambridge Jn in the Up and Fletton Jn in the Down.

Other Checks...



5 mile line diagrams

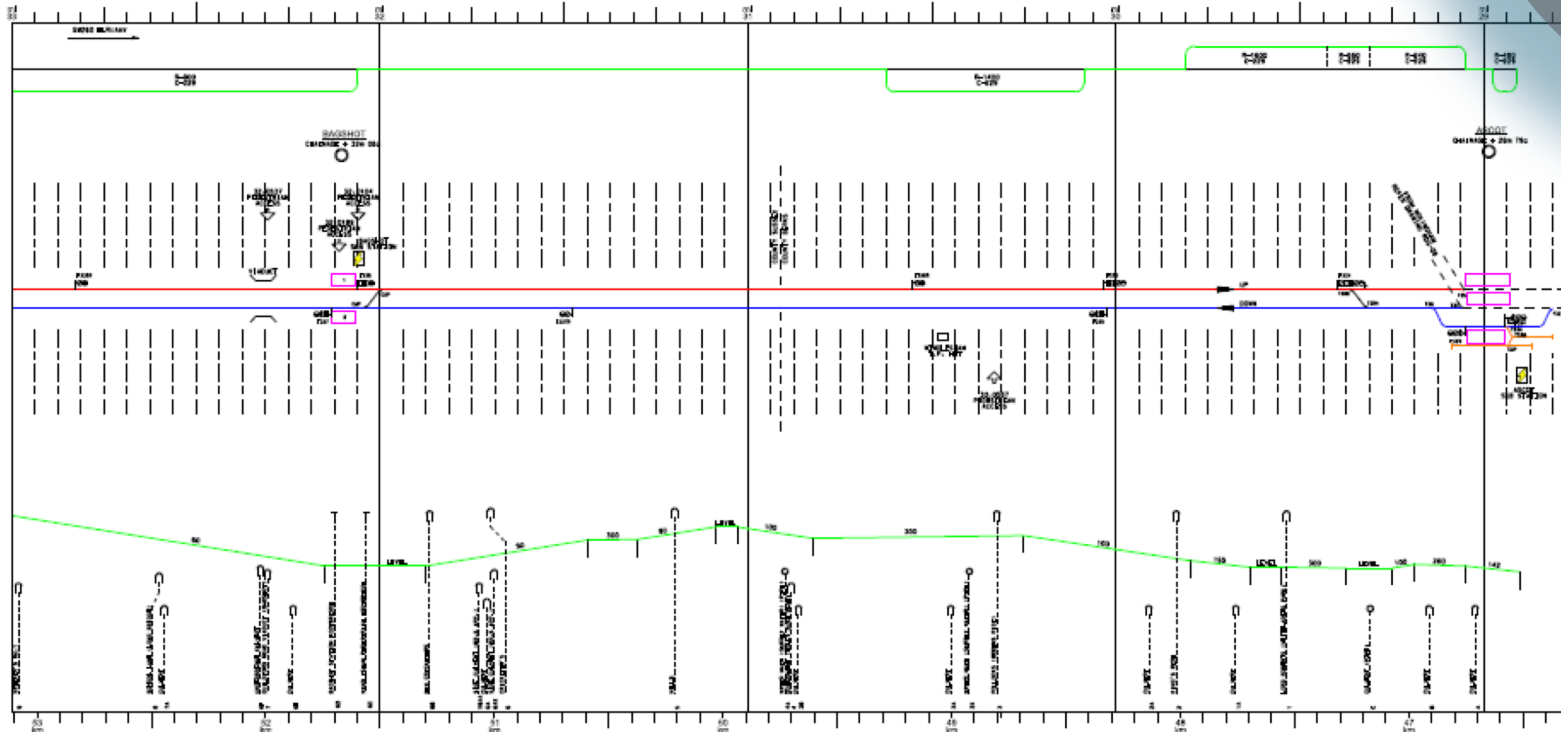

Example Route 1

6L10, Tunstead to West Thurrock

Loads Books

- 3 excel sheets
- 27 lines of data
- 30 minutes to gather

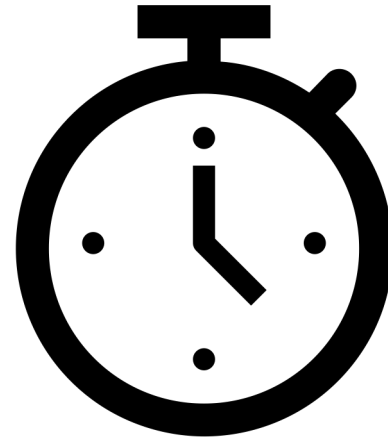

LDS087HAW

- 9 sections of route
- 10 minutes to validate

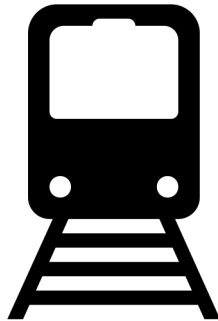

NESA

- 14 Lines of Route
- 20 minutes to gather

